

3D SYSTEMS[®]

CT-based anatomical
bone models

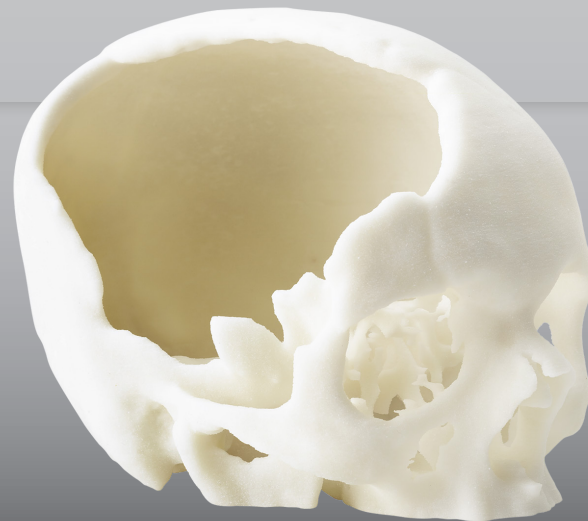

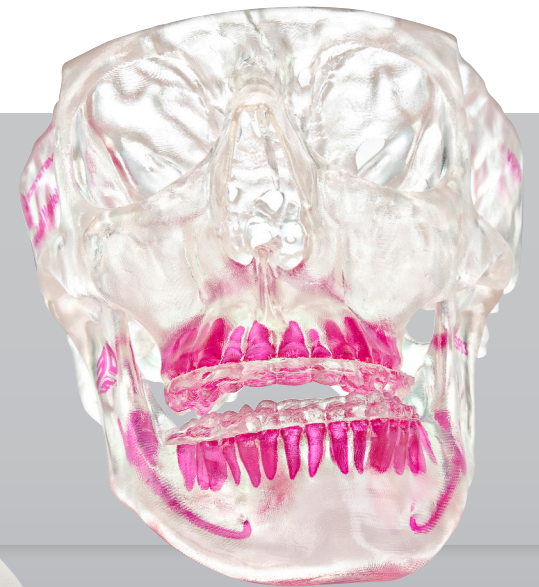



CT-based anatomical bone models

CT scanning guidelines





1. A 2-D axial, or helical CT scan without contrast done in the axial plane should be performed using 1mm x 1mm (or less) cuts to give the most accurate dataset. The patient should be positioned supine with occlusal plane parallel to the gantry. The scan should be performed using a standard algorithm (not bone or detail), using a 25cm field of view (FOV), and archived as uncompressed image data (Do **not** send raw data).
2. The CT scan facility will archive the image data from the scan to an optical disk or CD-ROM for transport to 3D Systems, Inc. (Do **not** send film). Certain facilities may also be able to FTP (file transfer protocol) this data for Internet transfer. Have the CT facility contact 3D Systems, Inc. to discuss different options for transfer of data. Optical disks will be returned to the scanning facility.
3. 3D Systems, Inc. supports all brands of scanners.

OsteoView anatomical models

| | Cat. No. | Qty | Description |
|---|------------|-----|--|
|  | 6500000011 | 1 | OsteoView mandible |
|  | 6500000012 | 1 | OsteoView maxilla |
|  | 6500000013 | 1 | OsteoView mandible and maxilla |
|  | 6500000014 | 1 | OsteoView full skull adult |
|  | 6500000015 | 1 | OsteoView full skull pediatric (up to 5 years) |

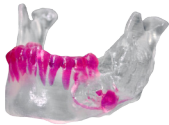
- Opaque physical appearance
- Low cost

ClearView anatomical models

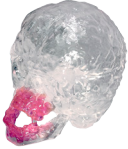
| | Cat. No. | Qty | Description |
|---|------------|-----|--|
|  | 6500000006 | 1 | ClearView mandible |
|  | 6500000007 | 1 | ClearView maxilla |
|  | 6500000008 | 1 | ClearView mandible and maxilla |
|  | 6500000009 | 1 | ClearView full skull adult |
|  | 6500000010 | 1 | ClearView full skull pediatric (up to 5 years) |

- Sub-millimeter accuracy
- Sterilizable material
- Selective coloration of vital structures

We offer CT-based anatomical bone models to help with pre-surgical planning for complex cases. Models can be used for distraction osteogenesis, orthognathics, skull based tumors and mandible and cranial reconstructions.

- Designed to increase OR efficiency through enhanced pre-operative planning
- Accurate 3-D models



Please visit
www.3dsystems.com/medicaldata for digital transfer of DICOM images.

Manufactured by:
 3D Systems Healthcare
 5381 South Alkire Circle
 Littleton, Colorado 80127 USA
 t: 844 643 1001 (toll-free US/Canada)
 t: 720 643 1001
 f: 720 643 1009
www.3dsystems.com/healthcare
anatomicalmodels@3dsystems.com
 MM-556 Rev A

Distributed by: stryker.com/cmfi
 Stryker Craniomaxillofacial
 Kalamazoo, MI 49002 USA
t: 269 389 5346
 toll free: 800 962 6558
 f: 877 648 7114
 CMF-FL-79 Rev. None 16143
 Copyright © 2017 Stryker
 Printed in USA

A surgeon must always rely on his or her own professional clinical judgment when deciding whether to use a particular product when treating a particular patient. Stryker does not dispense medical advice and recommends that surgeons be trained in the use of any particular product before using it in surgery. The information presented is intended to demonstrate the breadth of Stryker product offerings. A surgeon must always refer to the package insert, product label and/or instructions for use before using any Stryker product. Products may not be available in all markets because product availability is subject to the regulatory and/or medical practices in individual markets.

Stryker Corporation or its divisions or other corporate affiliated entities own, use or have applied for the following trademarks or service marks: Stryker. All other trademarks are trademarks of their respective owners or holders.

3D SYSTEMS is registered trademark of 3D Systems, Inc.